



beblaze®  
ITALIAN TOOLS TO MAKE LIGHT

Rev.0 - 27/04/2022



3 SDMC



L90 / 60.000Hrs



0,45 Kg



## BE\_BRIGHT Circle Ø20



### NOME / NAME

BMC00020 Apparecchio monoemissione per illuminazione / Single emission fixture

### DIMENSIONI / DIMENSION

025 Ø200 x 25mm

### INSTALLAZIONE / INSTALLATION

54 Indoor IP54

65 Outdoor IP65

### SCHERMO-OTTICA / COVER-OPTIC

OP Opale / Opal

### FINITURA / FINISHING \*

PI1

Vern. polvere Bianco RAL9010  
Powder coating White RAL9010

VL1

Vern. liquido Nero RAL9005  
Liquid paint Black RAL9005

(\*) Su richiesta sono disponibili ulteriori colori RAL / Additional RAL colour are available on demand

**CARATTERISTICHE TECNICHE / TECHNICAL DATA**

WHITE (1 CH)	Cod.	CV [Vdc]	W	Lm	Cod.	CCT	CRI
					CRI >90		
	<b>W24017</b>	24	17,3	1854	<b>279</b>	2700 K	> 90
	<b>W48017</b>	48	17.3	1854	<b>309</b>	3000 K	> 90
					<b>359</b>	3500 K	> 90
					<b>409</b>	4000 K	> 90
					<b>579</b>	5700 K	> 90

Condizioni / Conditions: Flux BIN P10 - Ta: 25°C

**ESEMPIO DI CODICE / EXAMPLE OF CODE**

CODICE: **BMC0002002565OPPI1W24017309**

DESCRIZIONE: **BE\_BRIGHT Circle Ø20**

Apparecchio monoemissione per illuminazione, dimensioni Ø200x25mm,  
IP65 Outdoor, corpo in lamiera piegata, verniciato a polvere bianco RAL9010 opaco, diffusore  
in PMMA opale  
LED WHITE 17,3W, CV 24V, 3000K 3SDCM CRI>90, cavo nero da 3m (2x0,75mm²), Cl.III

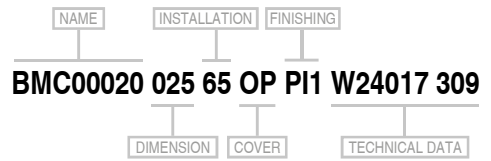

**DISEGNO / DRAWING**

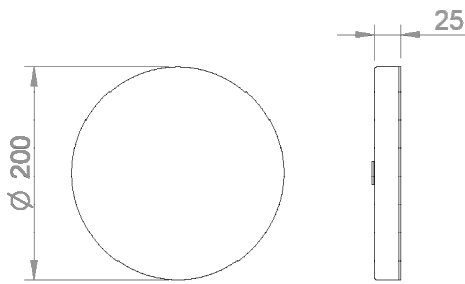

Unita di misura: mm / Unit of Measurement: mm

**GRAFICO POLARE / POLAR GRAPH**

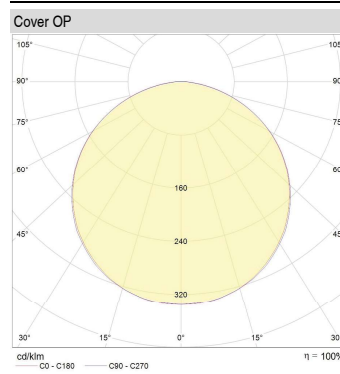

**GRAFICO CONICO / CONICAL GRAPH**

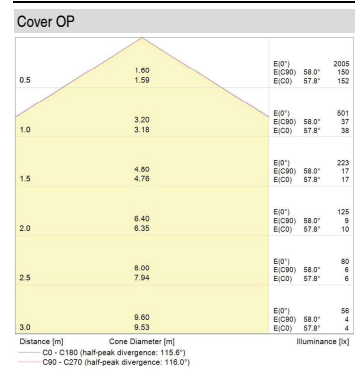

**ACCESSORI / ACCESSORIES**

SOFFITTO / CEILING: 4pz. Cod. **ASM21013012**

PARETE / WALL: 4pz. Cod. **ASM21013012**

SOSPENSIONE / SUSPENSION: 2pz. Cod. **ASM21013010**

